

Distributed by: BEST MATERIALS ®
 Ph: 800-474-7570, 602-272-8128
 www.BestMaterials.com Email: Sales@BestMaterials.com

#3 Phillips drive, 13 tpi, drill point
 For insulation attachment to wood and steel roof decks



- Available with #3 Phillips drive.
- Drill point design prevents fastener walking.
- 13 threads per inch provides higher pull-out values.
- Drill point cuts through gravel and BUR.
- e-coat

Application

#12 Dekfast Fasteners

Available pre-assembled and loose for insulation attachment to steel and wood.

Materials:

- Steel thickness from 22 ga (.028 in.) through 18 ga (.045 in.):
Min penetration: 3/4"
- Wood 2x (1-1/2" thick):
Min penetration: 1"
- Plywood: Min thickness: 3/4"
FR treated; min through penetration: 1/4"

Use with:

- Dekfast 3" round metal plates and 2-7/8" hex metal plates
- Dekfast 3" round plastic Dekflat plates

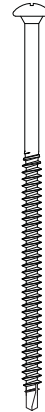
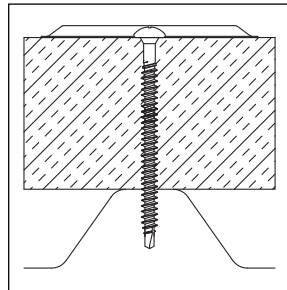

Head Types: #3 Phillips
 Head Height: Max .118"
 Head Dia: Max .448"
 Thread Major Dia: .222"
 Shank Dia: .167"

Strength (lbs ult.):

Tensile: 2410
 Torsional: 76 in-lbs min
 Shear: 1815

Pull-out (lbs avg.):

Steel 22 ga: 513
 Steel 20 ga: 695
 Steel 18 ga: 787
 2x dimensional lumber (1" penetration): 462
 3/4" FR Plywood (through penetration): 575

Notes

Dimensions are nominal inches unless noted. Ultimate values listed are the result of laboratory testing. Pull-out (pounds ultimate) strength values may vary from tabulated loads depending upon the uniqueness of the application. The specific job conditions should be considered and appropriate safety factors applied when specifying the proper fasteners.

Selection

Fastener Length	*Thread Length	Material No. Phillips Head	North American Code	Steel	Wood	Concrete	Carton Wt. (lbs)	Carton Qty.	Skid Qty.
1-5/8"	Full	785683	DF-#12x1-5/8-PH3-E0999-B	Up to 7/8"	Up to 5/8"	N/A	13	1,000	60,000
2-1/4"	Full	785698	DF-#12x2-1/4-PH3-E0999-B	5/8" to 1-1/2"	Up to 1-1/4"	N/A	17	1,000	60,000
2-7/8"	Full	785717	DF-#12x2-7/8-PH3-E0999-B	5/8" to 2-1/8"	Up to 1-1/8"	N/A	21	1,000	60,000
3-1/4"	3"	785735	DF-#12x3-1/4-PH3-E0999-B	1/2" to 2-1/2"	1/2" to 2-1/4"	N/A	23	1,000	60,000
3-3/4"	3"	785761	DF-#12x3-3/4-PH3-E0999-B	1" to 3"	1" to 2-3/4"	N/A	26	1,000	60,000
4-1/2"	4"	785781	DF-#12x4-1/2-PH3-E0999-B	3/4" to 3-3/4"	3/4" to 3-1/2"	N/A	31	1,000	40,000
5"	4"	785797	DF-#12x5-PH3-E0999-B	1-1/4" to 4-1/2"	1-1/4" to 4"	N/A	34	1,000	40,000
6"	4"	785818	DF-#12x6-PH3-E0999-B	2-1/4" to 5-1/4"	2-1/4" to 5"	N/A	41	1,000	40,000
7"	4"	785835	DF-#12x7-PH3-E0999-B	3-1/4" to 6-1/4"	3-1/4" to 6"	N/A	24	500	30,000
8"	4"	785851	DF-#12x8-PH3-E0999-B	4-1/4" to 7-1/4"	4-1/4" to 7"	N/A	28	500	30,000

* Note - Thread length measured from tip of the drill point to end of threads.

Approvals

Dekfast fasteners and plates are Factory Mutual approved for attachment of insulation board to roof deck. Refer to FM Approval Guide and Supplements for current FM approved insulation fastening patterns. #12 fasteners meet Factory Mutual corrosion-resistance Standard 4470.

Installation

Tools: 2000 – 2500 rpm screw guns with hardened #3 Phillips. #12 Dekfast fasteners can be pre-assembled with metal or plastic insulation plates. The standard carton package includes one #3 Phillips bit.

Options

