

isofast™ Plates

2-3/4" square, 2-3/8" round  
Stacked insulation and membrane plates  
used with the isofast™ fastening system

- "The fastest way to install roofing fasteners!"
- Belted fasteners and isofast plates increase productivity and are ergonomically correct, allowing the contractor to install the roof assembly in an upright position when using the IF160 installation tool.

- Displaces labor costs
- Reduces workman's' compensation claims as they relate to injuries incurred while installing fasteners.
- Reduces installation costs up to 50%.



Application

**IF-2.375-AT  
Membrane Plate**

- Use with:
- #15 Belted Fasteners

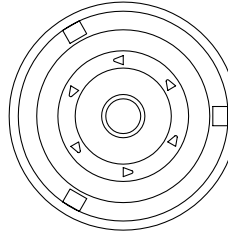
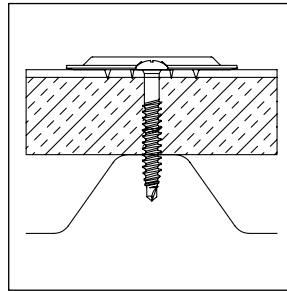

OD: 2 3/8" Round  
ID: .265"  
Thickness: .042"  
Finish: AZ50 Galvalume®

**IF-L-70 x 70  
Insulation Plate**

- Use with:
- #12 Belted Fasteners
  - #15 Belted Fasteners

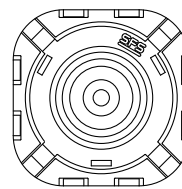
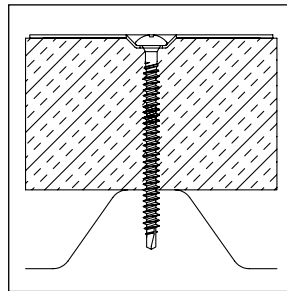

OD: 2-3/4" x 2-3/4" Square  
ID: .257"  
Thickness: .019"  
Finish: AZ50 Galvalume

**IF/IG-C 82x40  
Membrane Plate**

- Use with:
- #12 Belted Fasteners
  - #15 Belted Fasteners

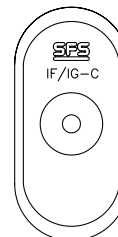
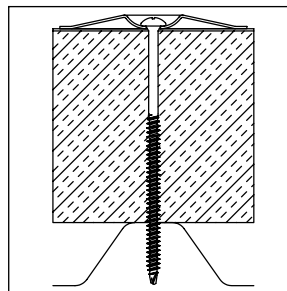

OD: 3-1/4" x 1-1/2" Oblong  
ID: .220"  
Thickness: .042"  
Finish: AZ50 Galvalume

Notes

Dimensions are nominal inches unless noted.

Continued on following page

## 2-3/4" square 2-3/8" round

Stacked insulation and membrane plates used with the isofast™ fastening system

## isofast™ Plates

### Selection

Description	Part No.	Carton Wt. (lbs)	Carton Qty.	Skid Qty.
2-3/8" Round	M7680	27	500	24,000
2-3/4" Square	M7710	29	750	40,500
3-1/4" x 1-1/2" Oblong	M7700	41	750	22,500

### Approvals

isofast fasteners and plates are FM approved for insulation and roof cover attachment. Refer to FM approval guide and its supplements for current approved fastening spacings.

### Installation

isofast plates are designed to be used with Isofast fasteners and the IF160 Installation tool. Use in applications approved by the roofing system manufacturer.

### Options

