

VersiWeld® ADHERED ROOFING SYSTEM

FOR USE WHEN VERSIWELD MEMBRANE IS ADHERED DIRECTLY OVER
 NEW LIGHTWEIGHT INSULATING CONCRETE (SEE SPECIFICATIONS)

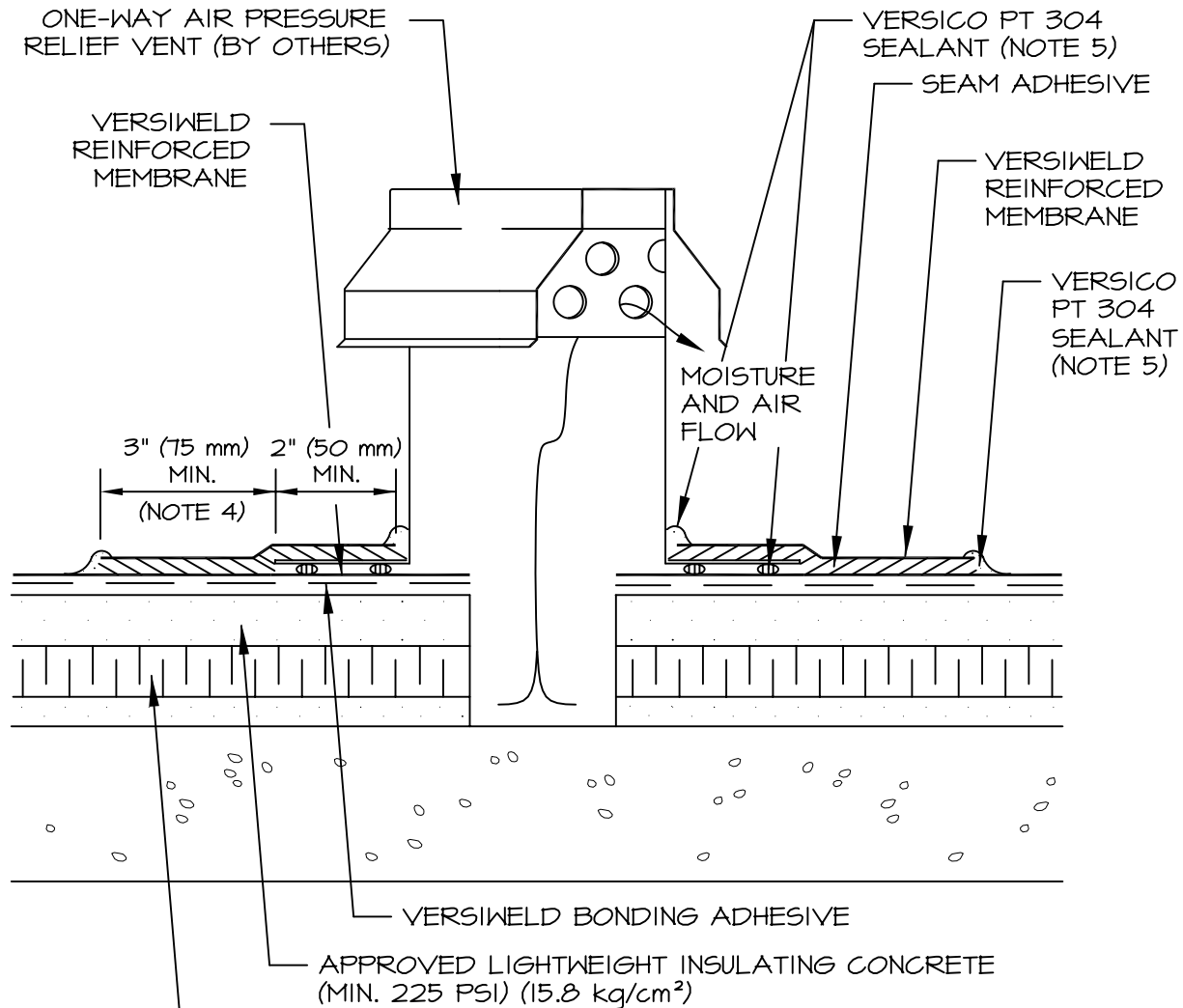

NOTES:

1. CONTACT VERSICO FOR ACCEPTABLE PRESSURE RELIEF VENTS.
2. POSITION VENTS AT THE RATE OF ONE VENT PER 2000 SQ. FT. (186 m²).
3. PRIOR TO APPLYING SEAM ADHESIVE, CLEAN METAL FLANGE WITH WEATHERED MEMBRANE CLEANER.
4. A MINIMUM 1-1/2" (40 mm) HOT AIR WELD MAY BE PROVIDED IN LIEU OF SEAM ADHESIVE (USE CUT-EDGE SEALANT IN LIEU OF PT 304 SEALANT).
5. V-150 PRIMER MUST BE USED TO PREPARE SURFACES PRIOR TO APPLYING VERSICO PT 304 SEALANT.

VWA-8
 ONE-WAY AIR PRESSURE
 RELIEF VENT

VERSICO
 INCORPORATED



A subsidiary of Carlisle SynTec Incorporated
 © 2006 VERSICO INCORPORATED