

isofast® Plates

2-3/4" square, 2-3/8" round
Stacked insulation and membrane plates
used with the isofast® fastening system

- "The fastest way to install roofing fasteners!"
- Belted fasteners and isofast plates increase productivity and are ergonomically correct, allowing the contractor to install the roof assembly in an upright position when using the IF 160 or IF 240 installation tools.

- Displaces labor costs.
- Reduces workman's compensation claims as they relate to injuries incurred while installing fasteners.
- Reduces installation costs up to 50%.



Application

**IF-2.375-AT
Membrane Plate**

- Use with:
- #15 Belted Fasteners

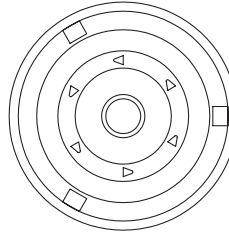
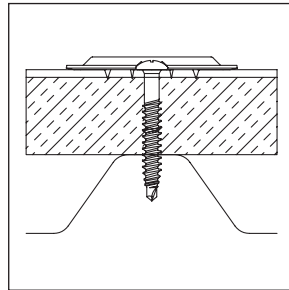

OD: 2 3/8" Round
ID: .265"
Thickness: .042"
Finish: AZ50 Galvalume®

**IF-L-70 x 70
Insulation Plate**

- Use with:
- #12 Belted Fasteners
 - #15 Belted Fasteners

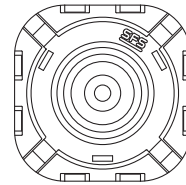
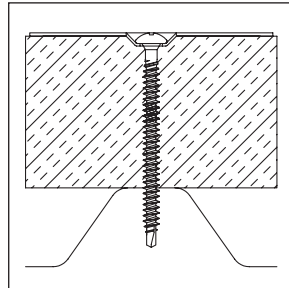

OD: 2-3/4" x 2-3/4" Square
ID: .257"
Thickness: .019"
Finish: AZ50 Galvalume

**IF/IG-C 82x40
Membrane Plate**

- Use with:
- #12 Belted Fasteners
 - #15 Belted Fasteners

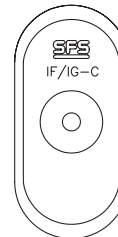
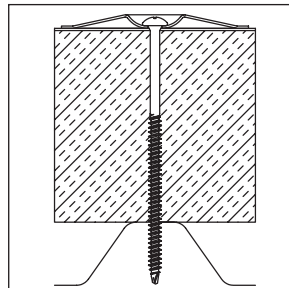

OD: 3-1/4" x 1-1/2" Oblong
ID: .220"
Thickness: .042"
Finish: AZ50 Galvalume

Notes

Dimensions are nominal inches unless noted. The specific job conditions should be considered and appropriate safety factors applied when specifying the proper fasteners.

Distributed by: **BEST MATERIALS®**
Ph: 800-474-7570, 602-272-8128 Fax: 602-272-8014
www.BestMaterials.com Email: Sales@BestMaterials.com

Continued on following page

isofast® Plates

2-3/4" square, 2-3/8" round
Stacked insulation and membrane plates
used with the isofast® fastening system

Selection

Description	Original Part No.	North American Code	Carton Wt. (lbs)	Carton Qty.	Skid Qty.
2-3/8" Round	M7680-TPL	PLT-R-2-3/8-BL	41	500	31,500
2-3/4" Square	M7710-TPL	PLT-S-2-3/4x2-3/4-BL	41	750	40,500
3-1/4" x 1-1/2" Oblong	M7700-TPL	PLT-O-3-1/4x1-1/2-BL	37	750	18,250

Approvals

isofast fasteners and plates are FM approved for insulation and roof cover attachment. Refer to FM approval guide and its supplements for current approved fastening spacings.

Installation

isofast plates are designed to be used with isofast fasteners and the IF 160 or IF 240 installation tools. Use in applications approved by the roofing system manufacturer.

Options

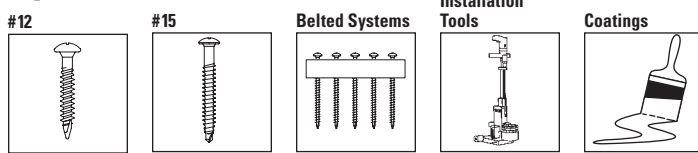

Distributed by: **BEST MATERIALS®**
Ph: 800-474-7570, 602-272-8128 Fax: 602-272-8014
www.BestMaterials.com Email: Sales@BestMaterials.com