



CemBase Asphalt Fortifier

Product Data Sheet

For more information
Or to buy this product
[Click here](#)



PRODUCT DESCRIPTION

StreetBond® CemBase Asphalt Fortifier is a high-performance cementitious, epoxy-modified acrylic based, waterborne surfacing product designed for application on stamped (textured) asphalt pavements only. **StreetBond® CemBase Asphalt Fortifier** fortifies asphalt pavement to help resist scuffing on weaker stamped asphalt such as driveways or pathways. **StreetBond® CemBase Asphalt Fortifier** is worker safe, environmentally safe, creates no unpleasant odors (during or after installation) and meets EPA requirements for Volatile Organic Compounds (VOC). **StreetBond® CemBase Asphalt Fortifier** and **StreetBond® SB150** are fully recyclable with the asphalt. **StreetBond® SB150's** friction properties are suitable for both pedestrian and vehicular applications.

WARRANTY

See applicable warranties and guarantees for complete coverage and restrictions.

PACKAGING & SHELF LIFE

One unit (box) of **StreetBond® CemBase Asphalt Fortifier** consists of:

- One 1.6 gallon (6.0 liter) jug of **StreetBond® CemBase Asphalt Fortifier Resin**
- One Bag of Dry hardener and silica aggregate.
- One Chosen **StreetBond® Colorant** (sold separately)

Shelf life 24 months if unopened containers stored between 40°F and 90°F (4°C and 32°C).

GAF Liquid-Applied

January 2016, supercedes December 2014

For technical, system, and warranty information, visit gaf.com or call 1-800-766-3411.

RECOMMENDED USES

- **StreetBond® CemBase Asphalt Fortifier** fortifies asphalt pavement to help resist scuffing on weaker stamped asphalt such as driveways or pathways.
- Applied as the two initial layers in a **StreetBond®** application over a printed surface that needs fortification.
- **StreetBond® CemBase Asphalt Fortifier** is combined with **StreetBond® Colorants** to offer a wide range of colors and can also be combined with **StreetBond® Solar Reflective (SR) Colorants** to produce a cool pavement surfaces for compliance with LEED specifications for urban heat island mitigation and to provide more comfortable environments.
- **StreetBond® CemBase Asphalt Fortifier** is applied in two layers as a base coat and must always be covered with at least one layer **StreetBond® SB150**. For example, if a project would typical require four layers of **StreetBond® SB150** on a stamped asphalt surface, a project needing fortification would have two layers of **StreetBond® CemBase Asphalt Fortifier** applied, followed by two layers of **StreetBond® SB150**.

PRODUCT CHARACTERISTICS

CEMBASE ASPHALT FORTIFIER	
Volume Solids	60% ±2% (ASTM D2697)
Weight Solids	74% ±2% (ASTM D2369)
VOC (calculated)	<25 g/L
Freeze Point	32°F (0°C)
Density	14.2 lb/gal (1.70 g/mL)
Mandrel Bend	3/8" @ 21°C
Water Absorption	10.2%
Permeance	13.43g/m ² / 24hr/mmHg (52 mils)

Application Temperature	+50°F to 105°F (Ambient) (10°C to 40°C)
Drying Time (Touch Dry)	1-4 hours at 77°F (25°C) and 40% humidity (ASTM D5695)
Taber Abrasion (Dry)	0.41 g/100 cycles
Taber Abrasion (Wet)	6.92 g/100 cycles

APPLICATION INSTRUCTIONS

Mixing Instructions: Shake resin jug and pour contents into a clean 5 gallon pail. Add colorant and ½ a jug of water (1/3 jug for cool days and 2/3 jug for hot days). Mix liquid for 30 seconds to evenly distribute the colorant. While continuing to mix, slowly add the bag of dry hardener and continue mixing for 3 minutes once the bag is empty. Product must be used **immediately**.

Surface Preparation: Dirt, debris, water and contaminants sitting on the surface will affect adhesion. Thoroughly clean surface using a broom and backpack blower or, in severe situations, use a power washer.

Areas containing chemical contaminants such as vehicle fluids need to be treated using a degreasing solution. Proper removal of contaminants and degreasing solution is necessary prior to coating application. Care should be taken to ensure that the substrate is dry before applying the coating.

Consult the **StreetBond®** Substrate Guide if unsure of the quality of the surface. An environmentally-friendly cleaner should be used. **StreetBond®** Adhesion Promoter may be used for polished asphalt. No precipitation should be expected within 24 hours.

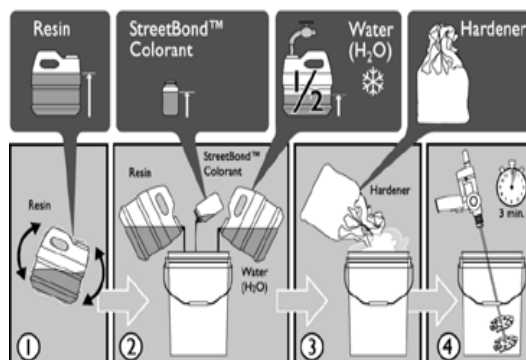

continued on back



CemBase Asphalt Fortifier

Product Data Sheet

APPLICATION INSTRUCTIONS, CONT'D

Recommended Application: StreetBond® CemBase Asphalt Fortifier may be applied in thin coats by brush, roller or textured sprayer. It should always be applied in two layers as a base coat. Base coat must always be covered with at least one layer **StreetBond® SB150**. Consult the most

up-to-date **StreetBond®** Stamped Surface Specification at gaf.com for more details. Coating must be allowed to cure before introducing traffic. Cure times vary based on climate conditions and range between 6-24 hours.

Recommended Application Coverage Rates:

# OF LAYERS	COVERAGE (approx)		THICKNESS (approx)			
	ft ² /unit*	m ² /unit*	WET		DRY	
			mm	mil	mm	mil
2	300	28	0.56	20	0.32	12

*1 unit is a nominal 5 gallon pail comprising Part A, Part B Hardener and Colorant (approximately 3.56 – 4.12 gallons). 1 unit when sprayed as a single layer covers approximately 600 ft² (55.7 m²), with an approximate thickness of 6.3 mil (0.16mm) dry.

LIMITATIONS & PRECAUTIONS

Do not allow material to harden in any equipment. DO NOT apply on a flat unstamped surface. The coating will cause cracking on flat surfaces.

Product will set up quickly in hot conditions, mix only what can be used immediately. Use ice water when mixing on hot

days. Ambient and surface temperatures must be 50°F (10°C) and rising before coating application. Do not ship or store unless protection from freezing is available.

SAFETY & HANDLING

For specific information regarding safe handling of this material please refer to the Safety Data Sheet (SDS).

CLEAN UP

Thoroughly rinse application equipment with clean water before it dries.

See applicable warranties and guarantees for complete coverage and restrictions.