

DISTRIBUTED BY



TW-S-D12 Facade Attachment

For more information
Or to buy this product
[Click here](#)

Application

Facade/cladding panel to wood

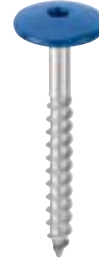
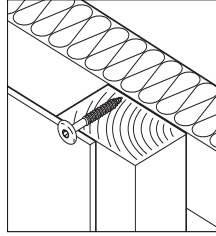

Features and Benefits

- 304 Stainless steel provides maximum corrosion resistance.
- Low profile drive head for aesthetically pleasing appearance.
- Color matched Vista spray available to blend with facade panel.

Product Selection

Material No.	Fastener Length		*Thread Length		Description	Carton Wt. (lbs.)	Carton Qty.
	(in)	(mm)	(in)	(mm)			
902988	1	25	19/32	15	TW-S-D12-4.8x25	2.2	250
986742	1-3/16	30	25/32	20	TW-S-D12-4.8x30	2.4	250
625848	1-1/2	38	1-3/32	28	TW-S-D12-4.8x38	2.7	250
698813	1-3/4	44	1-11/32	34	TW-S-D12-4.8x44	2.9	250
55443	2-3/8	60	1-31/32	50	TW-S-D12-4.8x60	3.7	250

* Note - Thread length measured from tip of the drill point to end of threads.

The details stated are results of tests and/or calculations and therefore are non-binding and do not represent warranties or warranted characteristics for not specified applications. All calculations therefore have to be checked and approved by the responsible planner ahead of execution. The user is responsible to assure compliance with all applicable laws and regulations.



TW-S-D12 Facade Attachment

CAD Drawing: TW-S-D12-R1

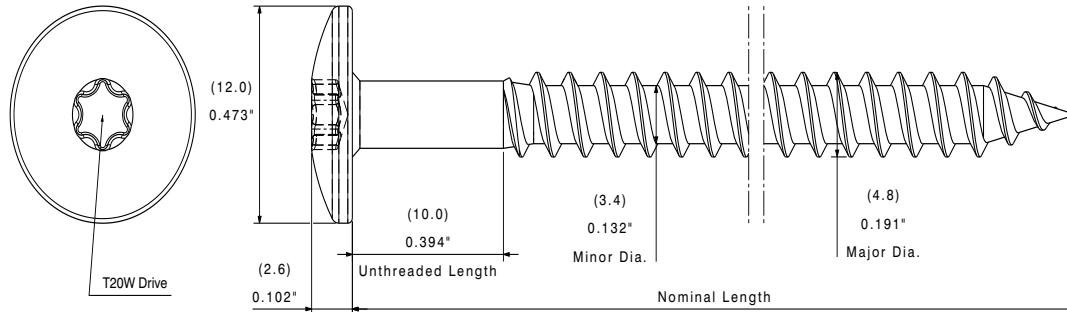

Product Specifications

Diameter:	#10 (4.8mm)	Drill Point:	Type A
Threads Per Inch:	12	Thread Major Dia:	0.191" (4.8mm)
Head Style:	0.473" (12.0mm) Dome Head	Thread Minor Dia:	0.132" (3.4mm)
Drive:	T20W		

Performance Data^{1,2,3}

		Pull Out Strength		
		SYP Dimensional Lumber	Plywood	OSB (Oriented Strand Board)
Tensile	1592 lbf / 7082 N			
Shear	1214 lbf / 5400 N			
Torsional	60 lbf*in / 6.6 N*m	1x4: 481 lbf / 2140 N	3/4" (19.1mm): 578 lbf / 2571 N 5/8" (15.9mm): 438 lbf / 1948 N 1/2" (12.7mm): 348 lbf / 1548 N	23/32" (18.3mm): 449 lbf / 1997 N 19/32" (15.1mm): 412 lbf / 1833 N 7/16" (11.1mm): 228 lbf / 1014 N

¹ SFS 4407.07

² CHTV 2016

³ SFS 4450.08

Installation and Application Considerations

Install fasteners with 0-2500 RPM screw gun equipped with depth sensing nose piece.

Use of T20W drive bit is required.

Fastener length should provide for a minimum of 1" (25.4mm) penetration into wood substrate. Check with cladding panel manufacturer for specific installation guidelines.

Use of impact guns or hammer drills is not recommended.

Metric values are approximate conversions.

The details stated are results of tests and/or calculations and therefore are non-binding and do not represent warranties or warranted characteristics for not specified applications. All calculations therefore have to be checked and approved by the responsible planner ahead of execution. The user is responsible to assure compliance with all applicable laws and regulations.