

# SENCO®

# SNS200XP Stapler Parts Chart

**Repair Kits**  
**YK0840**  
**YK0841**



Senco Brands Inc.  
4270 Ivy Pointe Blvd.  
Cincinnati, Ohio 45245  
Visit Our Website: [www.senco.com](http://www.senco.com)  
EMEA Website: [www.senco-emea.com](http://www.senco-emea.com)

Questions? Comments? call Senco at:  
1-800-543-4596 (North and South America Only)

# SNS200XP STAPLER

**SENCO®**

# Contents Of YK0840 Repair Kit  
 ## Contents Of YK0841 Repair Kit

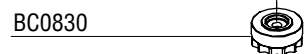
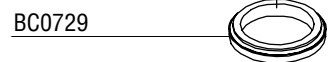
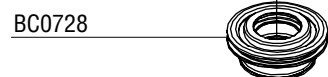
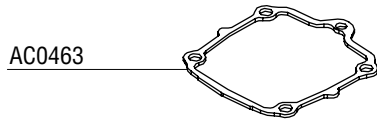
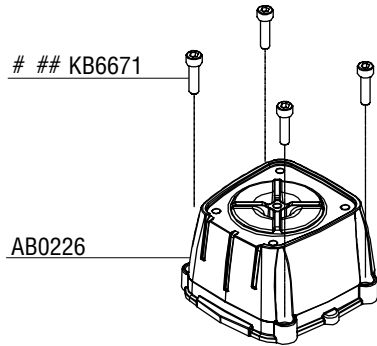
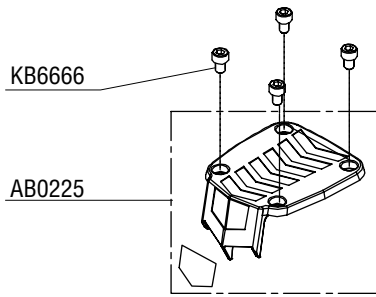

Tool #	Model
7B0001N	Contact-Actuation
7B2001N	Contact-Actuation

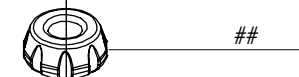
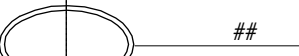
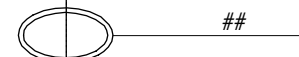
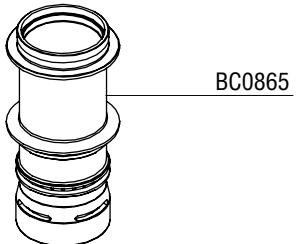



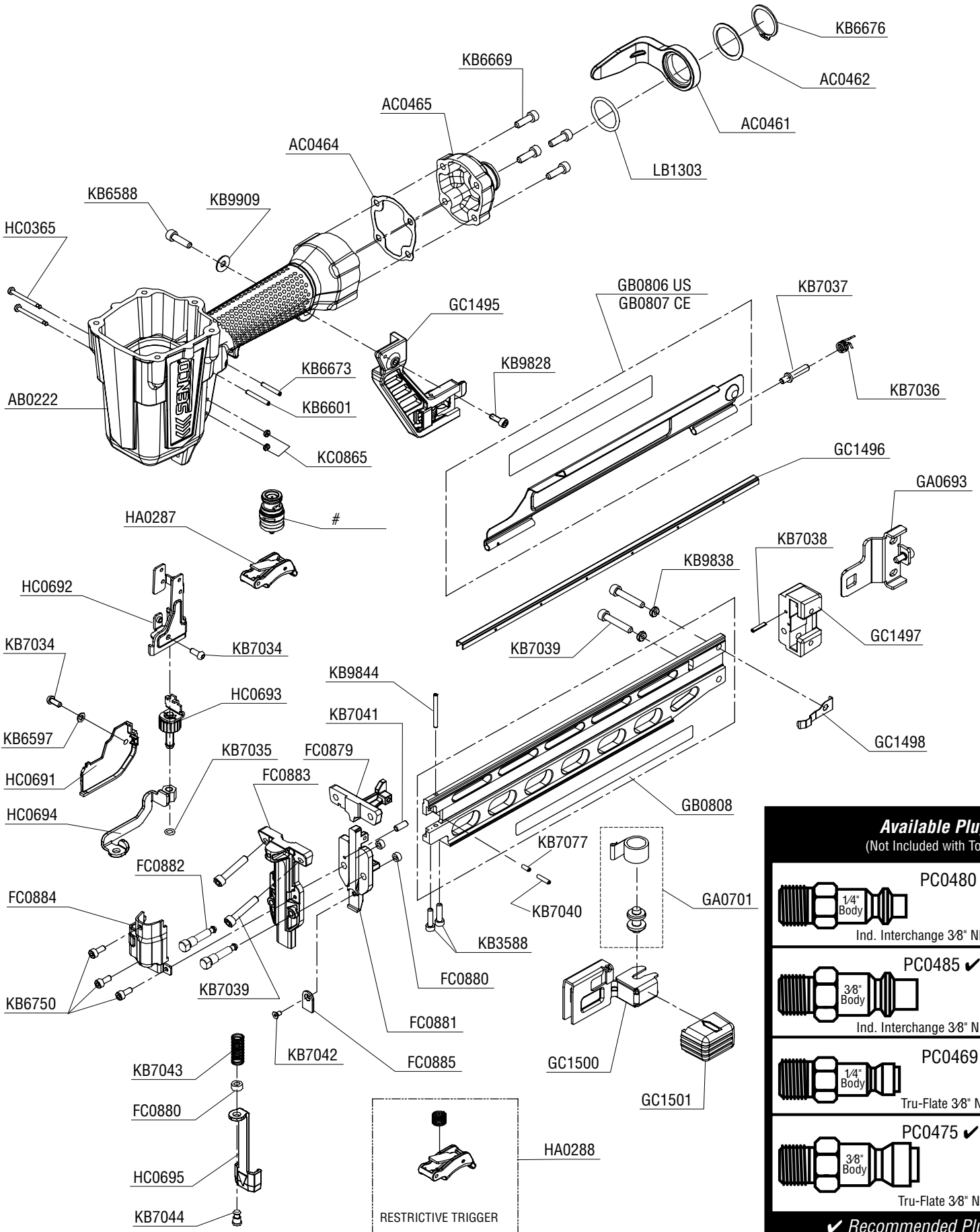

# SNS200XP STAPLER

**SENCO**



### Available Plugs (Not Included with Tool)

	<b>PC0480</b> Ind. Interchange 3/8" NPT
	<b>PC0485</b> ✓ Ind. Interchange 3/8" NPT
	<b>PC0469</b> Tru-Flate 3/8" NPT
	<b>PC0475</b> ✓ Tru-Flate 3/8" NPT

✓ **Recommended Plugs**  
Plugs shown smaller than actual size

# SNS200XP STAPLER

REPLACEMENT PARTS LIST • LISTA DE PARTES DE REPUESTO • ERSATSTEILE-LISTE • LISTE DE PIÈCES DE RECHANGE

PART NO.	DESCRIPTION	DESCRIPCIÓN	BESCHREIBUNG	DÉSIGNATION
AB0222	MAIN BODY	CARCASA	GEHÄUSE	CORPS
AB0225	COVER , EXHAUST	CUBIERTA	ABDECKUNG	COUVERCLE
AB0226	CAP	TAPA	KAPPE	BOUCHON
AC0461	BELT HOOK	GANCHO DE CINTURON	GURTHAKEN	CROCHET DE CEINTURE
AC0462	WASHER	ARANDELA	SCHEIBE	RONDELLE
AC0463	GASKET	SEAL	DICHTUNG	JOINT
AC0464	GASKET	SEAL	DICHTUNG	JOINT
AC0465	END CAP	TAPA TERMINAL	ABSCHLUßKAPPE	BOUCHON D'EXTRÉMITÉ DE RAIL
BC0727	STOP	TOPPE	PUFFER	ARRÊT
BC0728	VALVE	VÁLVULA	VENTIL	VALVE
BC0729	VALVE , FIRING	VÁLVULA	VENTIL	VALVE
BC0731	WASHER	ARANDELA	SCHEIBE	RONDELLE
BC0732	SEAL	SELLO	DICHTUNG	JOINT
BC0734	PLATE	PLACA	PLATTE	PLAQUE
BC0737	SPRING	RESORTE	FEDER	RESSORT
BC0830	VALVE , EXHAUST	VÁLVULA	VENTIL	VALVE
BC0865	CYLINDER SLEEVE	CILINDRO	ZYLINDER	CYLINDRE
BC0866	WASHER	ARANDELA	SCHEIBE	RONDELLE
EA0295	PISTON / DRIVER ASY	PERCUSOR	TREIBER	COUVEAU
FC0879	PLATE	PLACA	PLATTE	PLAQUE
FC0880	RING	ANILLO	REIFEN	ANNEAU
FC0881	BACK PLATE	PLACA	PLATTE	PLAQUE
FC0882	PIN	PASADOR	STIFT	GOUPILLE
FC0883	FRONT PLATE	PLACA	PLATTE	PLAQUE
FC0884	COVER	CUBIERTA	ABDECKUNG	COUVERCLE
FC0885	PLATE	PLACA	PLATTE	PLAQUE
GA0693	LATCH ASSY	ASAMBLE DE UÑETA	VERSCHLUSS-ZUSAMMENBAU	DOIGT DE RETENUE
GA0701	SPRING ROLLER	RODILLO	ROLLE	GALET
GB0806	MAGAZINE COVER (US)	CUBIERTA	ABDECKUNG	COUVERCLE
GB0807	MAGAZINE COVER (CE)	CUBIERTA	ABDECKUNG	COUVERCLE
GB0808	MAGAZINE ASY	ASAMBLE DE CARGADOR	MAGAZIN-ZUSAMMENBAU	MAGASIN D'ASSEMBLÉE
GC1495	BRACKET, MAGAZINE	SOPORTE	HALTERUNG	SUPPORT DE FIXATION
GC1496	RAIL	CARRIL	SCHIENE	RAIL
GC1497	END CAP	TAPA TERMINAL	ABSCHLUßKAPPE	BOUCHON D'EXTRÉMITÉ DE RAIL
GC1498	DETAINER	RETENEDOR	SPERRE	ARRÊT
GC1500	FEEDER	ALIMENTADOR	VORSCHIEBER	POUSSOIR
GC1501	GRIP	AGARRADERO	GRIFF	GAINE EN CUIR
HA0287	TRIGGER ASSY (contact-actuation)	ASAMBLE DE GATILLO	AUSLÖSER	ENSEMBLE GÂCHETTE
HA0288	TRIGGER ASSY (single sequential)	ASAMBLE DE GATILLO	AUSLÖSER	ENSEMBLE GÂCHETTE
HC0365	PIN	PASADOR	STIFT	GOUPILLE
HC0691	COVER , SAFETY	CUBIERTA	ABDECKUNG	COUVERCLE
HC0692	GUIDE , SAFETY	GUÍA	FÜHRUNG	GUIDE
HC0693	SAFETY ELEMENT	SEGURO	SICHERHEITSVORRICHTUNG	PALPEUR DE SÉCURITÉ
HC0694	SAFETY ELEMENT	SEGURO	SICHERHEITSVORRICHTUNG	PALPEUR DE SÉCURITÉ
HC0695	LOWER SAFETY	ASAMBLE DE SEGURO	SICHERHEITSVORRICHTUNG	PALPEUR DE SÉCURITÉ
KB3588	SCREW M4*16	TORNILLO	SCHRAUBE	VIS
KB6588	NYLOK SCREW M5*18	TORNILLO	SCHRAUBE	VIS
KB6597	WASHER	ARANDELA	SCHEIBE	RONDELLE
KB6601	PIN	PASADOR	STIFT	GOUPILLE
KB6666	SCREW M5*8	TORNILLO	SCHRAUBE	VIS
KB6669	SCREW M5	TORNILLO	SCHRAUBE	VIS
KB6673	PIN	PASADOR	STIFT	GOUPILLE
KB6676	C-RING	ANILLO	REIFEN	ANNEAU
KB6750	SCREW M4*6	TORNILLO	SCHRAUBE	VIS
KB7034	SCREW 4*10	TORNILLO	SCHRAUBE	VIS
KB7035	C-RING	ANILLO	REIFEN	ANNEAU
KB7036	SPRING	MUELLE	FEDER	RESSORT
KB7037	PIN	PASADOR	STIFT	GOUPILLE
KB7038	PIN	PASADOR	STIFT	GOUPILLE
KB7039	NYLOK SCREW M5*28	TORNILLO	SCHRAUBE	VIS
KB7040	PIN	PASADOR	STIFT	GOUPILLE
KB7041	PIN	PASADOR	STIFT	GOUPILLE
KB7042	SCREW M3*6	TORNILLO	SCHRAUBE	VIS
KB7043	SPRING	MUELLE	FEDER	RESSORT
KB7044	PIN	PASADOR	STIFT	GOUPILLE
KB7077	PIN	PASADOR	STIFT	GOUPILLE
KB9828	SCREW M4*12	TORNILLO	SCHRAUBE	VIS
KB9838	WASHER	ARANDELA	SCHEIBE	RONDELLE
KB9844	PIN	PASADOR	STIFT	GOUPILLE
KB9909	WASHER 14*1T	ARANDELA	SCHEIBE	RONDELLE
KC0865	RETAINER	RETÉN	SICHERUNGSRING	RETENUE
LB1303	O-RING 24.5*3	SELLO	DICHTUNG	JOINT