

## Impax™ — 1/4" Drill Screws

## 1/4-14 and 1/4-20 Impax self-drill *For metal to metal*

- Precision cold forged assuring superior point strength and the fastest drilling time performance through high strength steel and nested purlins.
- Impax #2 point is designed with a reduced drill point diameter to provide higher pullout in single purlin attachment.
- Delivers ultimate performance in medium and heavy gage applications.
- Designed and engineered to have low driving and thread engagement torque and provide maximum clamp load.
- Corrosion resistant coating system.

### Application

#### 1/4-14 Impax HWH #2 Point and #3 Point Metal to metal

Drilling capacity:

#2 point: .050 – .150

#3 point: .050 – .210

Thickness is based on normal, single thickness purlin/girt or multiple material thickness combined for total.

Min projection: 3/16" of threads below substrate

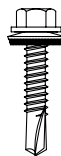
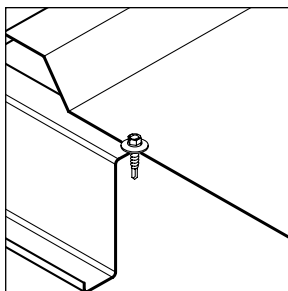

#2 – 5/16 AF Hex Washer Head  
#3 – 3/8" AF Hex Washer Head  
Thread Major Dia: .246 – .240  
Thread Minor Dia: .192 – .185

**Strength (lbs ult.):**

Tensile: 3800

Torsional: 150 in-lbs

Shear: 2850

**#2 Point Pull-out (lbs ult.):**

12 ga (.105): 2088

14 ga (.075): 1312

16 ga (.060): 903

**#3 Point Pull-out (lbs ult.):**

12 ga (.105): 1697

14 ga (.075): 1151

16 ga (.060): 687

**Pull-over with Bond Seal (lbs ult.):**

22 ga (.030): 1079

24 ga (.024): 884

26 ga (.018): 616

#### 1/4-20 Impax HWH #4 Point Metal to metal

Drilling capacity:

.060 – .250

Thickness is based on normal, single thickness purlin/girt or multiple material thickness combined for total.

Min projection: 3/16" of threads below substrate

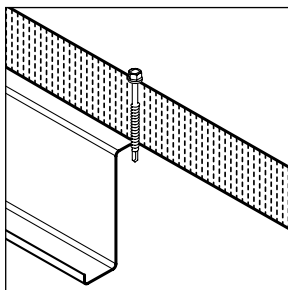

3/8" AF Hex Washer Head  
Thread Major Dia: .250 – .241  
Thread Minor Dia: .200 – .184

**Strength (lbs ult.):**

Tensile: 4200

Torsional: 156 in-lbs

Shear: 2920

**Pull-out (lbs ult.):**

12 ga (.030): 1913

14 ga (.024): 1061

16 ga (.018): 707

**Pull-over with Bond Seal (lbs ult.):**

22 ga (.030): 1117

24 ga (.024): 988

26 ga (.018): 629

### Notes

Dimensions are nominal inches unless noted. Self-drill pull-out values (pounds ultimate) are based on 57,000 psi hot rolled steel material. Ultimate values listed are the result of laboratory testing. The specific job conditions should be considered and appropriate safety factors applied when specifying the proper fasteners.

Distributed by: BEST MATERIALS LLC  
Ph: 800-474-7570, 602-272-8128 Fax: 602-272-8014  
www.BestMaterials.com Email: Sales@BestMaterials.com

Continued on following page

## Impax™ — 1/4" Drill Screws

1/4-14 and 1/4-20 Impax self-drill  
For metal to metal

## Selection

Length	Part No. #3 & #4 Point Bond Seal	Part No. #3 & #4 Point No Washer	Part No. #2 Point Bond Seal 5/16" HWH	Part No. #2 Point No Washer 5/16" HWH	Part No. #2 Point Bond Seal 3/8" HWH	Part No. #2 Point No Washer 3/8" HWH
1/4-14 x 3/4"	S5010-GBF	S5010F	—	—	—	—
1/4-14 x 1"	S5155-GBF	S5155F	—	—	S5171-GBF	S5171F
1/4-14 x 1-1/4"	S5201-GBF	S5201F	S5191-GBF	S5191F	—	—
1/4-14 x 1-1/2"	S5251-GBF	S5251F	S5286-GBF	S5286F	S5271-GBF	S5271F
1/4-14 x 2"	S5351-GBF	S5351F	—	—	—	—
1/4-14 x 2-1/2"	S5381-GBF	S5381F	—	—	—	—
1/4-14 x 3"	S5451-GBF	S5451F	—	—	—	—
1/4-14 x 4"	S5461-GBF	S5461F	—	—	—	—
1/4-20 x 3" #4 Point	S5611-GBF	S5611	—	—	—	—
1/4-20 x 4" #4 Point	S5621-GBF	S5621F	—	—	—	—
1/4-20 x 5" #4 Point	S5641-GB	S5641	—	—	—	—
1/4-20 x 6" #4 Point	S5661-GB	S5661	—	—	—	—
1/4-20 x 7" #4 Point	S5671-GB	S5671	—	—	—	—
1/4-20 x 8" #4 Point	S5681-GB	S5681	—	—	—	—

## Installation

Tools: 0 – 2000 rpm screwdriver equipped with depth sensing nosepiece.

## Options

VistaCoat™



Painted



Distributed by: BEST MATERIALS LLC  
 Ph: 800-474-7570, 602-272-8128 Fax: 602-272-8014  
[www.BestMaterials.com](http://www.BestMaterials.com) Email: [Sales@BestMaterials.com](mailto:Sales@BestMaterials.com)